

PLACAS Y CUCHILLAS PICADORA / MINCER PLATES AND KNIVES  
ENTERPRISE / UNGER

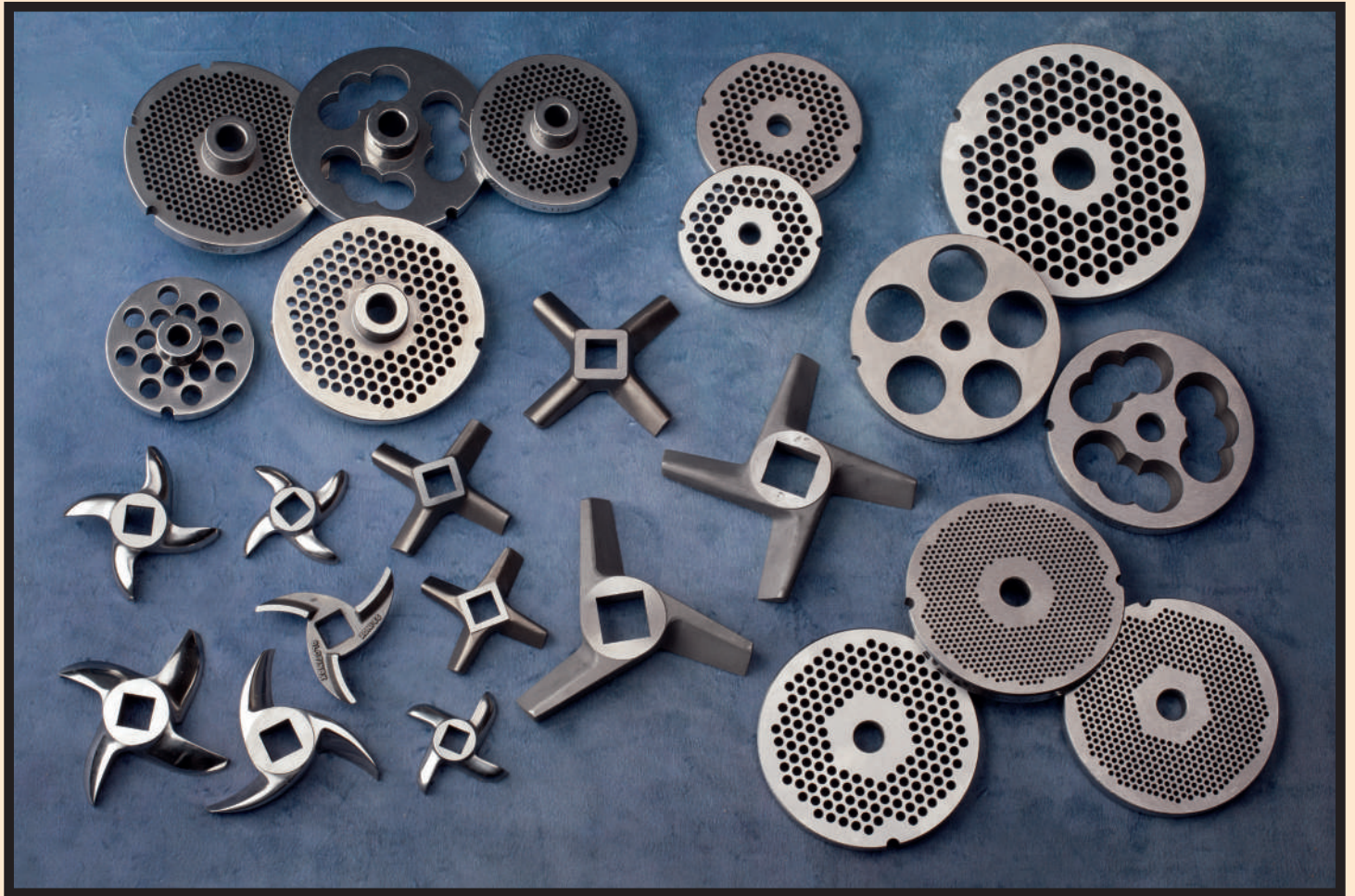

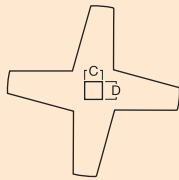

ENTERPRISE

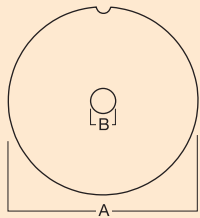
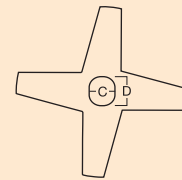
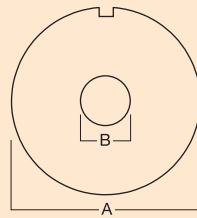

UNGER

### ENTERPRISE

Picadora / Mincer	8	12	22	32	42/52	56	66
Ø Placa (A) Ø Plate (A)	62	70	82	100	130	152	219
Ø Agujero central (B) Ø Center hole (B)	9.5	10	11.5	13.5	20	20	32
Eje cuchilla (Cx D) Knife axle (Cx D)	10.4	11.7	13.2	15.1	21.6	21.6	40

Medidas aproximadas / Approximate measurements

Otros modelos disponibles / Other models available

### UNGER

Picadora / Mincer	R70	H82	A90	B98
Ø Placa (A) Ø Plate (A)	70	82	90	98
Ø Agujero central (B) Ø Center hole (B)	17	22	24	26
Eje cuchilla (Cx D) Knife axle (Cx D)	9 x 12	12 x 16	15 x 18	15 x 19

Medidas aproximadas / Approximate measurements

Otros modelos disponibles / Other models available

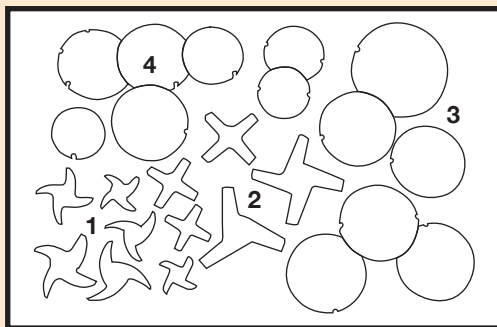

### ENTERPRISE

- 1\_ Cuchillas inox (AUT) / Stainless Steel knives (AUT)
- 2\_ Cuchillas acero forjado (T) / Forged Steel knives (T)
- 3\_ Placas inox / Stainless Steel plates
- 4\_ Placas inox con pivote / Stainless Steel plates with hub

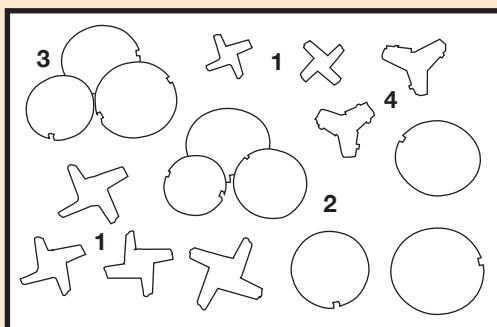

### UNGER

- 1\_ Cuchillas acero forjado "corte inclinado" / Forged Steel knives "Inclined cut"
- 2\_ Placas inox / Stainless Steel plates
- 3\_ Placas precorte inox / Stainless Steel pre-cut plates
- 4\_ Cuchillas con hojas cambiables inox / Insert blades knives stainless steel

